



rainbow[®]

BASED ON THE PRINCIPLE THAT

Wet Dust Can't Fly[®]

THE RAINBOW[®] USES

The Power of Water[®]

TO EFFECTIVELY REMOVE DIRT AND
AIRBORNE PARTICLES FROM YOUR HOME.



customer care number

As part of Rexair's Customer Care program, each Rainbow and Power Nozzle receives a Customer Care serial number only after passing Quality Control assurance testing. This serial number provides:

- ✓ Ownership identification for you
- ✓ Warranty identification for your Distributor
- ✓ Assurance of passing Quality Control testing
- ✓ Assurance of "factory-fresh" condition

For future reference, record the serial number in the space provided below. No authentic, new Rainbow or Power Nozzle should be sold without this number. If the serial number is missing, Rexair makes no claim as to the origin, age, or condition of the unit. If you are unable to locate a serial number on your Rainbow or Power Nozzle, please contact Rexair's customer service department.

RAINBOW SERIAL NUMBER

Model: e2 - 73 db(A)



YOUR AUTHORIZED RAINBOW DISTRIBUTOR

NAME	
ADDRESS	
CITY/STATE/POSTAL	
PHONE	
E-MAIL	

Contact your local Authorized Rainbow Distributor for advice on caring for your Rainbow, warranty coverage, replacement parts and service information.

A MESSAGE FROM REXAIR®

We would like to take this opportunity to congratulate and thank you for choosing the Rainbow Cleaning System. Your new Rainbow is the result of more than 75 years of continuous product research, development and ingenuity. Today, Rainbow products are sold in all 50 states and in more than 75 countries around the globe. We believe the Rainbow is the most effective and versatile home cleaning system available.

With proper use and care, the Rainbow will significantly improve your indoor living environment and provide years of reliable service. Please take a few minutes to review this guide and familiarize yourself with your new Rainbow Cleaning System.

Should you have questions or experience any issues with your Rainbow, please contact the Distributor or dealer from whom you purchased your Rainbow. If you are unable to contact them, feel free to contact Rexair's customer service department for assistance.



Rexair is a proud member of the Direct Selling Association and adheres to the DSA's Code of Ethics.



The Rainbow® is certified **asthma & allergy friendly™** by the Asthma and Allergy Foundation of America*.

CERTIFIED
asthma & allergy
friendly™

Meets
ASP:03:03
Standard for
Vacuum Cleaners



Asthma and Allergy
Foundation of America
aafa.org/certified

* Asthma & ALLERGY FRIENDLY and ASTHMA & ALLERGY FRIENDLY LOGO are Certification Marks and Trademarks of ALLERGY STANDARDS LIMITED. THE ASTHMA AND ALLERGY FOUNDATION OF AMERICA is a Registered Trademark of AAFA.

Rexair®
LLC

50 W. Big Beaver Road, Suite 350
Troy, Michigan 48084
United States of America

(248) 643-7222

custserv@rexairllc.com
rainbowsystem.com

Rainbow®, RainbowMate®, RainMate®, AquaMate®, Rexair®, The Power of Water®, Wet Dust Can't Fly® and the configuration of the Rainbow® Cleaning System are registered trademarks of Rexair LLC, Troy, Michigan, United States.

important safety instructions



PLEASE READ ALL INSTRUCTIONS BEFORE USING THESE APPLIANCES
USE ONLY MANUFACTURER'S RECOMMENDED ATTACHMENTS

WARNING: The electrified hose contains electrical wires and should be inspected regularly. Do not use if damaged, cut or punctured. Avoid picking up sharp objects. Do not use or repair a damaged hose. Contact an Authorized Rainbow Distributor or Service Center for repair. Do not immerse handle in liquid for cleaning. Use electrified hose only with Rainbow accessories or on carpet moistened by the Rainbow cleaning process. Always turn off this appliance before connecting or disconnecting the hose or motorized nozzle.

WARNING: Because of the danger of shock, any electrical appliance should be used only as directed. There should be no unapproved use of any electrical product. Electrical leakage and shorts can occur whenever there is electricity. If the user is standing on the ground, in a basement or in a room where a film of water can reach the ground, severe shock could result. Therefore, use the Rainbow only as directed in this Owner's Manual.

CAUTION: The Rainbow water basin will not trap materials that are resistant to the wetting action of water, including oily or greasy compounds (such as soot or ashes) and powdery substances (such as ceramic, drywall or plaster dust). Do not use the Rainbow to pick up or in the vicinity of any volatile or toxic materials.

1. This appliance can be used by children aged from 8 years and above and persons with reduced physical, sensory or mental capabilities or lack of experience and knowledge if they have been given supervision or instruction concerning use of the appliance in a safe way and understand the hazards involved. Children shall not play with the appliance. Cleaning and user maintenance shall not be made by children without supervision.
2. Unplug the Rainbow when not in use. Turn it off at the master switch before unplugging. Grasp the plug to disconnect it from the wall outlet to avoid damage to cord, plug, prongs or receptacle. Do not pull or carry by cord, use cord as a handle, close a door on cord, pull or carry around sharp edges or corners. Do not run appliance over cord. Keep cord away from heated surfaces. Do not use with damaged cord or plug.
3. Do not leave appliance when plugged in. Unplug Rainbow from outlet when unattended and before servicing or replacing the drive belt in motorized nozzles.
4. If your Rainbow or Rainbow accessory is in disrepair, do not attempt to operate. If the Rainbow is not working properly, has been dropped, damaged, left outdoors or dropped into water, contact an Authorized Rainbow Distributor or Service Center for inspection.
5. Do not clean the unit or unclog the hose until the Rainbow is switched off and the plug is removed from the wall outlet.
6. Do not connect to the receptacle of an incandescent light fixture or use any extension cords. Do not use with portable transformers or voltage converters.
7. Do not use the Rainbow or Rainbow accessory to unplug drains. If sewer gas is drawn into the Rainbow, it could cause an explosion.

8. Never touch a metal sink, cold or hot water pipe with one hand while touching the metal parts of any electrical appliance, light fixture or switch with the other hand. Your body could complete an electrical circuit to the ground. Additionally, wet skin surfaces can greatly increase this hazard. Do not handle plug or appliances with wet hands.
9. (A) Do not put any objects into openings; Do not use with any openings blocked; keep free of dust, lint, hair and anything that may reduce airflow; (B) Keep hair, loose clothing, fingers and all parts of the body from openings and moving parts; (C) Use extra care when cleaning on stairs.
10. Do not pick up anything that is burning or smoking, such as cigarettes, matches or hot ashes. Do not use to pick up flammable or combustible liquids, such as gasoline, or use in areas where they may be present.
11. To avoid the possibility of fire or explosion, do not use Rainbow or Rainbow accessories in areas where flammable and/or explosive vapor or dust is present. Some cleaning fluids can produce such vapors. Areas where flammable cleaning fluids have been used should be completely dry and thoroughly aired before being vacuumed.
12. This appliance is provided with double insulation. Use only identical replacement parts. See instructions for servicing of double-insulated appliances.
13. The Rainbow is equipped with an interlock switch that prevents the unit from operating if the water basin is not properly latched. **DO NOT ATTEMPT TO OVERRIDE THIS SAFETY FEATURE.**
14. Your Rainbow Power Nozzle contains a powerful revolving brush. To avoid bodily injury, the Rainbow Power Nozzle should not be placed against or close to loose clothing, jewelry, hair or body surfaces while Rainbow is connected to electrical outlet. The Power Nozzle does NOT protect against bodily injury or damage to objects that contact the revolving brush.
15. To reduce the risk of electric shock, this appliance may have a polarized plug (one blade is different than the other). This plug will fit in a polarized outlet only one way. If the plug does not fit fully in the outlet, reverse the plug. If it still does not fit, contact a qualified electrician to install the proper outlet. Do not change the plug in any way.
16. If the cord is damaged, turn off the power switch on the Rainbow and unplug the unit. Power cords must be replaced by an Authorized Rainbow Distributor.
17. Do not operate any fan with a damaged cord or plug. Discard fan or return to an Authorized service facility for examination and/or repair.
18. Do not run cord under carpeting. Do not cover cord with throw rugs, runners, or similar coverings. Do not route cord under furniture or appliances. Arrange cord away from traffic area and where it will not be tripped over.
19. This is a professional high-power piece of equipment and can cause electromagnetic interference. Please contact your local utility company regarding any special supply connection requirements.

**SAVE THESE
INSTRUCTIONS**

THIS APPLIANCE IS INTENDED FOR HOUSEHOLD USE ONLY
USE THE RAINBOW ONLY AS DIRECTED IN THIS OWNER'S MANUAL
rainbowsystem.com

SERVICING OF DOUBLE-INSULATED APPLIANCE

In a double-insulated appliance, two systems of insulation are provided instead of grounding. No grounding means is provided on a double-insulated appliance, nor should a means for grounding be added to the appliance. Servicing a double-insulated appliance requires extreme care and knowledge of the system and should be done only by qualified Rainbow service personnel. Replacement parts for a double-insulated appliance must be identical to the parts they replace. A double-insulated appliance is marked with the words "DOUBLE-INSULATION" or "DOUBLE-INSULATED." The Symbol (square within a square) may also be marked on the appliance. Any servicing other than cleaning should be performed by an Authorized Rainbow Distributor or Service Center.



get acquainted with your rainbow®



To purchase accessories or replacement parts,
please contact an Authorized Rainbow Distributor.

- | | | |
|--------------------------|--|-----------------------------|
| 1. Cord Wrap | 12. Separator | 22. Pistol Grip Hose Handle |
| 2. Exhaust Vent Plate | 13. Water Basin | 23. Hose Handle Trigger |
| 3. Exhaust Air Opening | 14. Dolly | 24. Hose Handle Wand |
| 4. Airflow Adapter | 15. Dolly Foot Latch | 25. Airflow Control Vent |
| 5. Power Selector Switch | 16. HEPA Neutralizer | 26. Crevice Tool |
| 6. Handle | 17. Confined Space Cleaner & Inflator Tool | 27. Dusting Brush |
| 7. Power Unit | 18. Refrigerator Coil Cleaner | 28. Upholstery Tool |
| 8. Air Inlet Opening | 19. Floor & Wall Brush | 29. Electrified Hose |
| 9. Water Basin Latches | 20. Cushion Bag (Not shown) | 30. Power Nozzle* |
| 10. Attachment Caddy | 21. Cleaning Wands | |
| 11. Separator Nut | | |

* Shown with optional Power Nozzle

power & control at your fingertips

Power Selector Switch

The power selector switch controls the speed of the Rainbow's motor.



HIGH: Use this setting for general cleaning.

OFF: Turns the entire unit off.

LOW: Use this setting for cleaning the air. (See page 13.)

Airflow Control Vent

The airflow control vent on the hose handle can be opened or closed to control airflow when vacuuming delicate items such as curtains and to make the Power Nozzle easier to push on dense carpet. As you clean, you can quickly determine the proper adjustment.

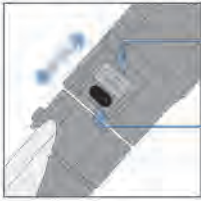

REDUCED AIRFLOW: Keep vent open and adjust as needed for different cleaning jobs.

FULL POWER: Keep vent fully closed for maximum cleaning performance.

Trigger Lock Switch

The hose handle's trigger lock switch controls the functionality of the electrified hose when using the Power Nozzle, RainbowMate, RainJet and AquaMate.

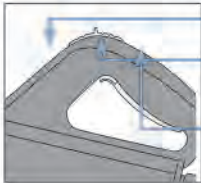

FORWARD POSITION: Locks trigger - power is off.

MIDDLE POSITION: (Recommended) Squeeze trigger to activate or release to turn off.

BACKWARD POSITION: Trigger is locked - power is on.

Attachment Caddy



Bring along your most used tools as you clean from room-to-room using the convenient onboard Attachment Caddy. Attach to the front of the Rainbow by slipping over the front of the housing into notches located on either side. Press downward to lock in place. Attachments are stored by slipping them over the posts on the caddy. The attachment caddy can also be attached to the wand.

quick-start guide

In just a few quick steps, you'll have your Rainbow assembled and ready to begin cleaning.

1. Fill water basin...

Start with cool water from the faucet. Fill the water basin until the top of the dome in the bottom of the basin is covered. Overfilling or under filling will reduce cleaning performance. Water should be replaced when water action is visibly reduced.

2. Clamp Rainbow to water basin...

Align and set the Rainbow on top of the water basin. Hook the two water basin latches on each side of the Rainbow to the rim of the water basin and snap up. To disconnect from water basin, release the two clamps and lift Rainbow. The Rainbow will not operate without the water basin attached.

3. Place Rainbow on dolly...

Place Rainbow with water basin attached on dolly, matching the protruding end of the Rainbow with the protruding end of the dolly as shown. A foot latch locks Rainbow into place. To release, press foot latch.

4. Attach hose...

Press hose coupling into air inlet opening of power unit until hose clicks. To remove, squeeze both latches and pull hose from power unit.

5. Connect Wands...

Insert the male end of one wand into the female end of second wand. Press wands together until button lock clicks. To disconnect, press button on wands and pull apart.

6. Connect hose-handle wand...

Insert the hose-handle wand into the female end of top wand. Push until button lock clicks. To disconnect, press button on wand and pull apart.

7. Select an attachment...

Determine what type of cleaning you will be performing (see chart on page 11), then insert the desired attachment into the bottom wand or pistol grip hose handle wand. Button will lock into hole on either wand. To disconnect, press button on wand and pull off.

8. Plug in the Rainbow and turn on...

Plug the power cord into your most convenient wall outlet. Select HIGH for maximum cleaning performance.

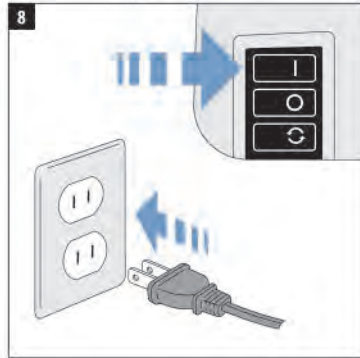
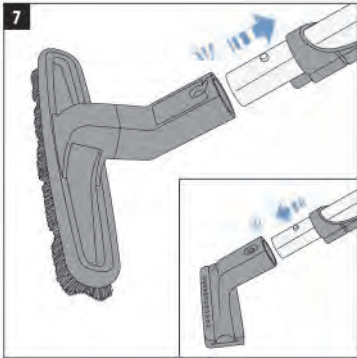
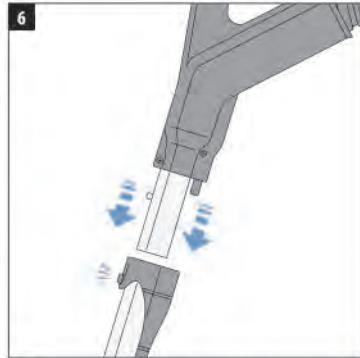
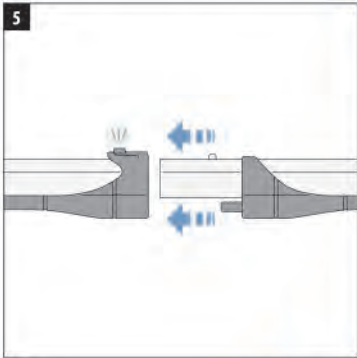
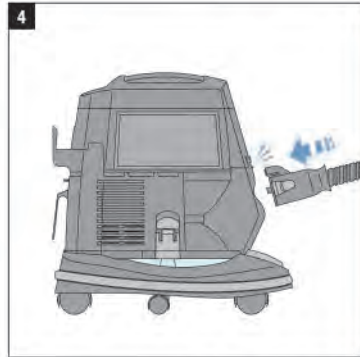
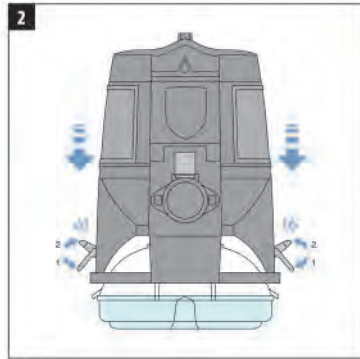
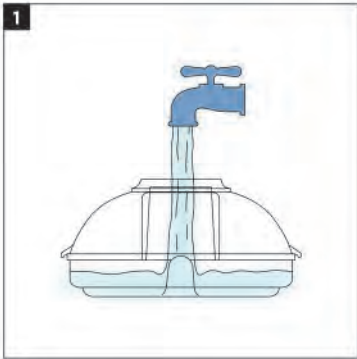

proper use & care

Following a few basic maintenance routines will help provide you with years of trouble-free service from your Rainbow Cleaning System. Neglecting all or part of these instructions may lead to decreased cleaning efficiency and potentially unnecessary service expenses.

Change the water when dirty...

Do not clean too long with one filling of water. Check water during cleaning, and if water becomes too thick with lint and dirt, empty water basin and add fresh, clean water. The correct water level is the top of the post in the center of the water basin. Never fill the water basin above this post.



Always empty and clean the water basin...

Immediately after using the Rainbow, remove the water basin and pour out the dirty water through the air intake opening. Heavier particles will settle to the bottom of the basin as the water is poured. Once water is poured, remove the remaining heavier debris and dispose. Then wash the water basin with soap and water. Rinse and dry thoroughly. **Do not** store the Rainbow on top of the water basin.

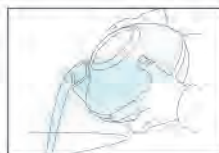

CAUTION: Always remove, empty and wash the water basin when cleaning job is finished. This helps to avoid odors, growth of germs and bacteria, and the development of water scum in the basin. Hand wash only. Not dishwasher safe.

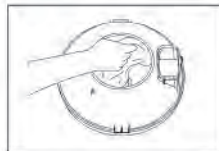

Clean the separator...

For best performance, remove and clean the separator frequently. If necessary, use the supplied Rainbow Separator Brush/Wrench to loosen the nut. Clean separator inside and out with soap and water using the Rainbow Separator Brush. Clean and dry the flange under the separator. Immediately after cleaning, dry and replace the separator. Hand-tighten the separator nut. Do not force the separator onto the threaded shaft.



WARNING: Always replace the separator immediately after cleaning (hand-tighten only). Do not operate the Rainbow without the separator.

Clearing an obstruction from the hose...

If you notice decreased airflow when using the hose, the hose may have become clogged. To clear obstruction, turn off Rainbow and disconnect from power source. Then, remove the exhaust vent door on the rear of the Rainbow. Connect the hose coupling to the exhaust air opening, making sure both latches are locked. Place the hose handle wand into the air intake opening on the front of the Rainbow. Turn the Rainbow on and jiggle the hose. Any dirt stuck in the hose will be trapped in the Rainbow water basin.



a complete home cleaning solution

The Rainbow's wide assortment of cleaning tools provide the power and versatility to clean practically everything around your home.

ATTACHMENT	Furniture	Between cushions	Window Treatments	Stairs	Bare Floors	Carpeted Floors & Rugs	Walls	Hard-to-Reach Spaces
Dusting Brush	✓		✓					
Upholstery Tool	✓		✓	✓				
Crevice Tool	✓	✓		✓				✓
Floor and Wall Brush				✓	✓		✓	
Power Nozzle*					✓	✓		
RainbowMate*	✓			✓				
RainJet*					✓			
Squeegee*					✓			
Rexafoamer*						✓		
Inflator / Confined-Space Cleaner		✓						✓

* Available as an optional accessory. For more information, contact an Authorized Rainbow Distributor.

CAUTION: Always clean attachments before using on fabrics. To avoid abrasions to delicate surfaces, keep the dusting brush bristles clean.

CAUTION: Do not use attachments to clean flat-screen televisions or computer screens.

Cleaning the attachments...

The floor and wall brush, dusting brush and upholstery tool can be whisked clean with the open end of Rainbow hose while Rainbow is running; or remove attachment and clean in warm, soapy water. Allow to dry before replacing. If bristles wear out or become damaged, contact your local Rainbow Distributor for replacement.

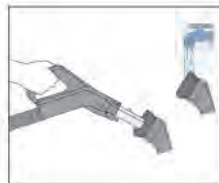

Using the Airflow Adaptor...

The Rainbow Airflow Adaptor reduces air noise through the air inlet opening. It is recommended to use the adaptor when the Rainbow is used as a blower or inflator. Simply snap the Airflow Adaptor into the air inlet opening before using the Rainbow as a blower or inflator.



a complete home cleaning solution

To clean bare floors...

Use the **floor & wall brush**. For clean and attractive looking hardwood floors and linoleum tile, the floor and wall brush does an outstanding job of removing surface litter and dirt. Consistent use will help prevent scratches caused by floor debris. Set Airflow Control to FULL POWER.



To clean carpeted floors...

Use the **Power Nozzle™**. The lightweight Rainbow Power Nozzle removes dirt from deep within your carpet and large rugs. Its powerful revolving brush loosens lint, threads, hair and dirt, leaving your carpet soft and clean. Active brush edge cleaners help remove dirt trapped along carpet edges, along baseboards or next to furniture. Set Airflow Control to FULL POWER.

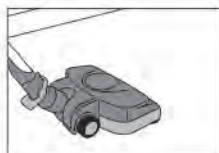

To dust...

Use the **dusting brush**. Because the Rainbow traps dust in water and releases only water-washed air back into the home, your home will require less dusting. However, to keep your home thoroughly clean, don't forget to dust overlooked places such as windowsills, picture frames, venetian blinds, lamp shades, lighting fixtures, moldings, houseplants, hats, clothing, screens, drapes and curtains. On lamp shades and similar fragile objects, reduce the suction by opening the Airflow Control Vent. For delicate objects, airflow may be further reduced. **TIP:** Attach the dusting brush to the optional extended hose* to reach ceiling fan blades, cornice boards and cobwebs.

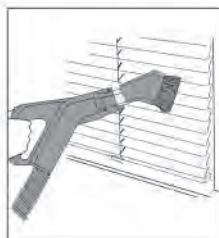

To clean walls...

Use the **floor & wall brush**. All walls ... papered, paneled or painted ... stay cleaner longer when dust and dirt are removed regularly. Start from the ceiling and make your way to the floor, using slow downward strokes. For best results, allow only the top edge of brush to contact the wall. With a slight space between the wall and bottom edge of brush, dust is removed before the bristles touch it, thus avoiding streaks. Set Airflow Control to FULL POWER.



To clean narrow spaces...

Use the **crevice tool**. Use the crevice tool to clean in narrow and tight spaces, such as between radiator sections, under radiators, along floor edges and baseboards and deep down between cushions. Set Airflow Control to FULL POWER.



To clean carpeted stairs...

Use the **upholstery tool**. To clean carpeted stairs, remove the Rainbow from the dolly. Allow the Rainbow to rest solidly on the stair above the one you are cleaning. Grasp the handle and move the Rainbow one step at a time as you continue cleaning each stair. Invert the upholstery tool 90 degrees to clean stair risers. Set Airflow Control to FULL POWER.

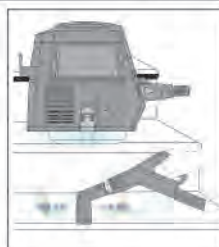

* Available as an optional accessory. For more information, contact an Authorized Rainbow Distributor.

a complete home cleaning solution

For fresh, water-washed air...

The Rainbow not only cleans your floors and furnishings, it cleans the air! Simply add water to the basin, position the Rainbow in the center of a room and run in low-speed mode for about one hour. The Rainbow will remove heavy odors, airborne dust and other particles from the air, trapping them in the water.



To deodorize...

Use **Rainbow Fresh Air Solution**.[®] Before using the Rainbow, simply add one capful of Rainbow Fresh Air Solution to the water in the basin. The Rainbow will quickly circulate and refresh the air in the entire area while you clean, alleviating many objectionable household odors.



To aromatize...

Use **Rainbow fragrances**. Add a few drops of any Rainbow fragrance to the water in the basin. Place the Rainbow in the center of the room and run in low-speed mode. In a matter of minutes, a pleasant fragrance will permeate your home.

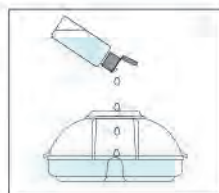

To clean furniture fabric...

Use the **upholstery tool**. Deeply embedded dirt can reduce the life and vibrancy of fabric. The Rainbow Upholstery Tool effectively removes dirt from upholstered furniture. With Rainbow's exclusive jet brush attached, surface litter and pet hair disappears like magic. Use the upholstery tool on sofas, chairs, mattresses, pillows, blankets, closet shelves, drapes and curtains. The upholstery tool may be used alone or with the Jet Brush attached. **TIP:** This tool is also great for gently cleaning clothing and outerwear - including wool, fur coats and delicate fabrics. Adjust Airflow Control to fit your cleaning situation.

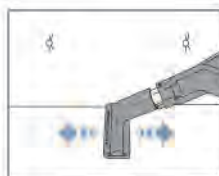

To clean vents...

Use the **dusting brush**. Floor and ceiling vents collect and recirculate dust throughout your home. The soft dusting brush bristles get in between the vent slots, easily removing stubborn dirt and trapped debris. Set Airflow Control to **FULL POWER**.

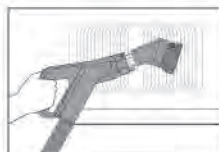

To fluff cushions and pillows...

Use the **cushion bag**. This handy plastic bag removes stale, dusty air from cushions and pillows and is sized to fit even your largest cushions. Begin by placing a cushion in the bag. With the upholstery tool attached to end of hose handle wand, hold the cushion bag tightly in place around the wand, turn on the Rainbow and watch as stale, dusty air is sucked out. Without letting go of the bag at the wand, disconnect the hose from the front of the Rainbow and attach to the Rainbow's exhaust air opening. Your cushion is now being "fluffed" with clean, water-washed air.



a complete home cleaning solution

To freshen bedding...

Use the Rainbow Power Nozzle. Mattresses, box springs, bed frames, pillows, coats and sleeping bags can be thoroughly cleaned with the Rainbow Cleaning System. Use the Rainbow Power Nozzle to loosen and eliminate hairs, dead skin, dust mites, crumbs and other particles from your bedding. **Caution:** Use of the Rainbow Power Nozzle on fine linens and soft bedding may cause damage.



To inflate or blow air...

Use the inflator tool. The Rainbow inflator tool works great for quickly inflating air mattresses, beach balls and other inflatable toys.

WARNING: Be sure inflator pin is properly locked in place. If not, it will be blown forcefully from the tool body.

INSTRUCTIONS:

1. Remove the rear exhaust panel on the Rainbow.
2. Attach Rainbow hose to exhaust opening.
3. Attach Inflator Tool to hose handle wand end.
4. Set Airflow Control Setting to FULL POWER.
5. Attach inflator tool to hose handle.
6. Carefully insert the inflator pin into the inflator stem of the object to be inflated.
7. Turn Rainbow switch to HIGH.

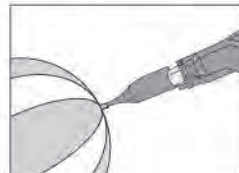
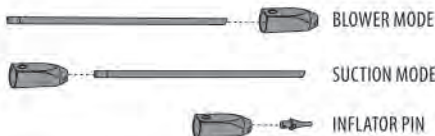

To clean tight areas...

Use the confined-space cleaner. For detailed cleaning of extra difficult-to-reach areas, use the confined-space cleaner. This versatile tool can be used with either the inflator pin or flexible coil cleaner, depending on your specific cleaning situation.

TIP: The confined-space cleaner works great for detailing the interior of your vehicle.

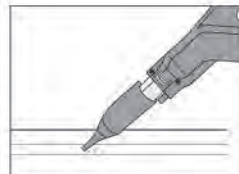

To clean under refrigerators...

Use the coil cleaner. One of the most commonly overlooked areas when cleaning the home is underneath the refrigerator. Refrigerator cooling coils attract dust and crumbs, and can become less effective and energy-efficient when covered in dirt. Due to its slender design, the coil cleaner can be used to easily vacuum off the visible cooling coils of your refrigerator and underneath your washer or dryer.

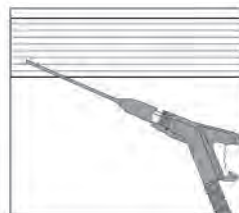

enhance your rainbow® with accessories

For more information about these products, please contact an Authorized Rainbow Distributor.



The AquaMate carpet cleaning extraction unit allows you to achieve professional results without the professional price tag. The AquaMate works effectively on most carpet types and dries quickly. Stains caused by spilled beverages, pets and tracked mud can be removed quickly. Your neighbors will think your carpets were professionally cleaned. Use with AquaMate Carpet Cleaning solution for superior cleaning results.



Goes where no mop has ever gone before. The RainJet's self-contained, large-capacity solution tank allows superior cleaning for those bigger cleaning jobs. The Sponge and Brush attachments can be used interchangeably on tile or linoleum floors to scrub away embedded dirt and debris. Flip the Sponge over and the Squeegee Pickup Blade leaves floors spotless. Use with Clean Floor solution for superior cleaning results.



The RainbowMate's sleek, lightweight design allows you to access and clean smaller surfaces such as stairs, upholstery and vehicle interiors. The RainbowMate has a motor-driven brush for maximum cleaning performance.



Ready for a Breath of Fresh Air? The RainMate gives you sweet-smelling air in the most practical, unique and attractive manner possible. Simply add a few squirts of your favorite Rainbow fragrance or Rainbow Fresh Air solution into the RainMate water basin and experience the great outdoors.

Jumbo Floor & Wall Brush

The 14-inch wide Jumbo Floor & Wall Brush covers a larger area, allowing you to clean large surface more quickly.

4-Quart (3.76 Liter) Water Basin

The 4-Quart Water Basin is available for larger cleaning jobs, allowing you to clean for longer periods without changing the water. The 4-Quart water basin fits the Rainbow dolly and doubles the cleaning capacity of the Rainbow.

Extended Hose

The 8-foot Extended Hose provides additional reach when using Rainbow attachments and the Power Nozzle. Convenient for cleaning large stairways and tall ceilings.

Rexafoamer

The Rexafoamer creates "dry" suds from liquid shampoo. Your rugs and carpets can be shampooed inexpensively, yet professionally, right in the home. Use with Rexafoamer Shampoo solution for superior cleaning results.

the rainbow® power nozzle™*

The lightweight Rainbow Power Nozzle removes dirt from deep within your carpet, large rugs and hard surface floors. Its powerful revolving brush loosens lint, threads, hair and dirt, leaving your carpet soft and clean. Adjustable rollers allow you to adjust the Rainbow Power Nozzle height as needed for various cleaning surfaces. Set Airflow Control to FULL POWER.

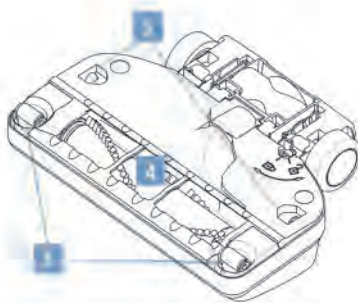
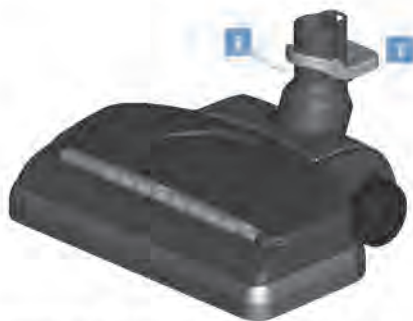

* Available as an optional accessory. For more information, contact an Authorized Rainbow Distributor.

1. Foot Release
2. Pivot Arm
3. Adjustable Rollers

4. Brush Roll
5. Sole Plate Release Tabs

Contact an Authorized Rainbow Distributor for replacement Power Nozzle belts and other supplies.

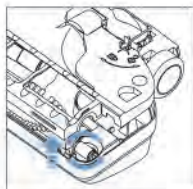

Adjustable Rollers...

The Rainbow Power Nozzle features adjustable rollers on both sides that allow you to maximize cleaning performance.

LOW: Typical setting for most carpets and surfaces.

HIGH: For deep pile carpeting and special applications.

⚠ WARNING: To avoid risk of electrical shock, NEVER pick up water or any other fluids with the Power Nozzle.

⚠ CAUTION: Use the Power Nozzle for dry pick-up only. Do not use outdoors or on wet surfaces.

⚠ CAUTION: Never pick up hard or sharp objects with the Rainbow Power Nozzle. Items such as pins, hairpins, tacks, crayons and pencil stubs may cause damage to the brush roll or belt.

⚠ CAUTION: Always make sure your Rainbow is unplugged before attaching your Power Nozzle.

⚠ CAUTION: Always disconnect unit from electrical supply when servicing.

⚠ CAUTION: Do not oil motor. The motor is permanently lubricated and sealed.

⚠ CAUTION: Consult flooring manufacturer prior to using the Rainbow Power Nozzle on bare hard surfaces. Then test the Power Nozzle in an inconspicuous location to verify the flooring is not damaged by use.

power nozzle™ assembly & operation

Assembly

- a. Prior to using the Power Nozzle, follow the Quick Start Guide on pages 8-9 to prepare the Rainbow.
- b. Insert the bottom wand with male end into the opening located on top of the Power Nozzle. Press downward until button lock clicks.

Operation

- a. Plug in the Rainbow.
- b. Turn the Rainbow power switch to HIGH mode.
- c. On the hose handle, turn the Airflow Control Vent to FULL POWER.
- d. To disengage from the upright position, place your left foot on top of the Power Nozzle. Next, grasp the wand assembly and pull backward.
- e. Squeeze the trigger on pistol grip hose handle to activate the Power Nozzle. Release trigger to turn Power Nozzle off. Optional: Use the trigger lock switch. (See page 7.)
- f. Guide Power Nozzle slowly back and forth over carpet with free and easy strokes. Let the Power Nozzle and Rainbow do the work.
- g. To lock Power Nozzle into the upright position, place your left foot on top of the Power Nozzle. Next, grasp the wand assembly and push forward until wand system is fully engaged in locking tabs.
- h. To disconnect the Power Nozzle from the wand, place your foot on the foot release above the pivot arm.

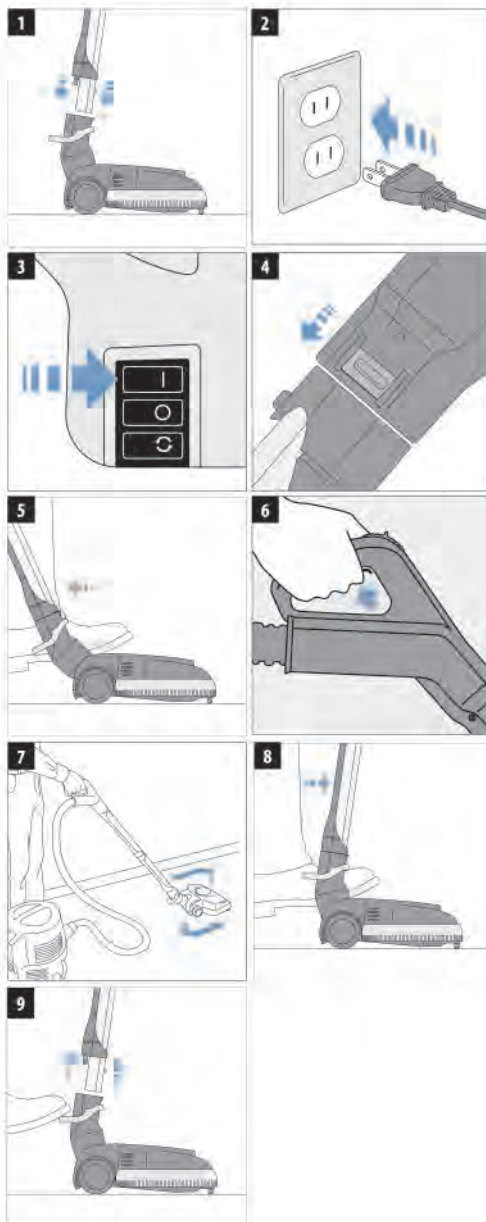

replacing the power nozzle™ belt

For best performance, we recommend you replace your Rainbow Power Nozzle belt every 12 to 18 months, or when you notice decreased cleaning performance. Your Power Nozzle comes with one replacement belt, and can be easily changed in just a few minutes. This replacement belt is located in the spare belt pocket under the sole plate. For additional replacement belts, contact an Authorized Rainbow Distributor.

WARNING: Always disconnect from electrical supply when servicing.

1. Turn the Power Nozzle upside down. Using a flat-bladed screwdriver or coin, turn the fastener a quarter-turn to the left (counterclockwise).
2. Using both thumbs, push tabs on both sides of sole plate outward while lifting to unlock.
3. Next, insert index fingers into two side openings near wheels. Pull side tabs up while pushing in to lift off sole plate.
4. Rotate brush roll assembly forward (note that rollers are upside down) and remove.
5. a) Slide worn or broken belt off motor shaft with finger; b) Lift brush roll out and remove worn belt.
6. Place new belt over the end of brush roll assembly. Position new belt around the pulley.
7. a) Place brush roll upside down with rollers centered on top of two side tabs. Slide belt over end of motor shaft; b) Rotate brush roll assembly forward until rollers are face up. Spin brush roll toward you to position the belt on the center of the pulley.
8. Position sole plate over top of Power Nozzle cover. Press down until front, two side tabs and back tabs snap and lock in.
9. Using a flat-bladed screwdriver or coin, turn the fastener a quarter-turn to the right (clockwise) to lock sole plate. Assembly is complete.

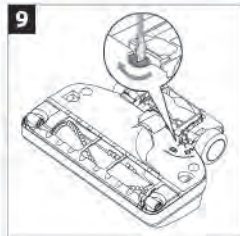
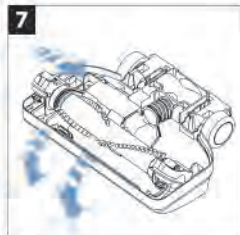
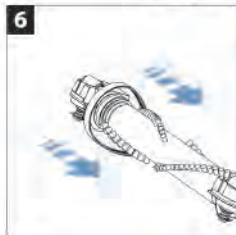
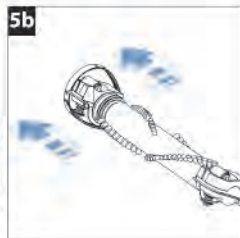
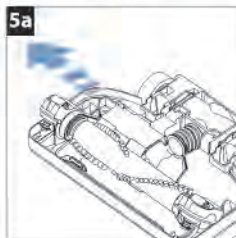
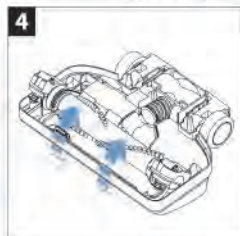
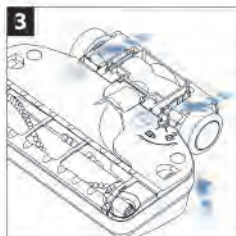
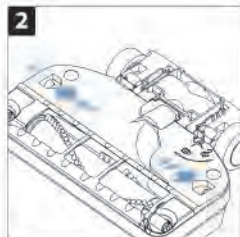
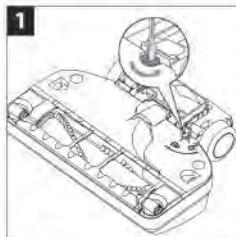

user troubleshooting guide

Your Rainbow® is equipped with a feature that disconnects the power to the accessory hose under certain abnormal conditions.



INDICATOR LIGHT CODE	POTENTIAL CAUSE	CORRECTIVE ACTION
Continuous Light	Unit is turned on while hose handle trigger is in "locked-on" position (Power Nozzle will emit pulsing sound).	Release hose handle trigger lock for 3 seconds. Resume normal use.
Blinks 2 Times, Repeats	Power Nozzle brush roll is obstructed.	Turn unit off / unplug unit. Remove debris from Power Nozzle brush roll. Resume normal operation.
	Electrical connections are wet.	Turn unit off / unplug unit. Dry electrical connections. Resume normal operation. If the corrective action does not fix the problem: Contact an Authorized Distributor or Service Center.
Blinks 4 Times, Repeats	Electrical connections are wet.	Turn unit off / unplug unit. Dry electrical connections. Resume normal operation. If the corrective action does not fix the problem: Contact an Authorized Distributor or Service Center.
Blinks 6 Times, Repeats	Electrical hose or wand connection problem.	Contact an Authorized Distributor or Service Center.

troubleshooting guide

This Rainbow appliance has been thoroughly tested and inspected. If a minor issue develops, the following troubleshooting procedures may help identify and correct the issue. If you are unable to resolve the issue, contact an Authorized Rainbow Distributor for service. Any service procedure not listed below should be performed by an Authorized Rainbow Distributor or Service Center.

⚠ WARNING: Disconnect electrical supply before performing maintenance to the unit. Failure to do so could result in electrical shock or personal injury.

ISSUE	POSSIBLE CAUSE	POSSIBLE SOLUTION
The Rainbow motor is not running	Rainbow not properly latched to water basin. Air inlet screen is plugged with debris.	Ensure side latches of water basin are locked.
	Not firmly plugged in.	Plug unit in firmly or try another outlet.
	Air inlet screen is plugged with debris.	Clean off debris thoroughly.
	Automatic resetting motor protector has tripped.	Turn Rainbow off. Leave off for 30 seconds. Turn Rainbow back on.
	Defective cord, switch or Rainbow.	Contact an Authorized Rainbow Distributor or Service Center.
Noticeably reduced airflow	Rainbow not correctly positioned on water basin.	Ensure Rainbow is properly seated and latched onto water basin.
	Plugged hose, wand, attachment or Power Nozzle.	Remove obstruction from clogged area.
	HEPA Neutralizer needs servicing or replacement.	Remove HEPA Neutralizer and clean or replace.
	Rainbow is running on low speed.	Turn power switch to high speed.
	Separator is clogged or dirty.	Remove separator and clean. (See page 10)
Unit discharges dust	Low level of water in basin.	Fill water basin to correct level.
	Excessively dirty water in basin.	Replace with clean water.
	Hole in HEPA Neutralizer.	Contact an Authorized Rainbow Distributor or Service Center.
Heavy foaming in water basin	Soapy contaminant in water basin.	Replace with clean water.
	High level of water in basin.	Empty water basin and refill to correct level.
Unit discharges a musty odor	Water basin not cleaned or dumped after use.	Clean water basin and use Deodorant Air Freshener while cleaning.
	Separator clogged or dirty.	Remove separator and clean. (See page 10)
	Damp HEPA Neutralizer.	Remove HEPA Neutralizer and clean or replace.

ISSUE	POSSIBLE CAUSE	POSSIBLE SOLUTION
	Rainbow stored on water basin.	Do not store Rainbow on water basin.
Machine running hot; Burning odor noticed	Plugged hose, wand, attachment or Power Nozzle	Remove obstruction from clogged area
	Rainbow not seated on water basin properly	Ensure Rainbow is properly seated and latched onto water basin
Unusual tone, noise or vibration	Separator clogged or dirty	Remove separator and clean
	Water level is above center dome in water basin	Empty water basin and refill to correct level
The Power Nozzle motor is not running	Trigger Lock Switch is in the off position.	Move the switch to the middle position and depress trigger.
	Handle switch is not activated.	Must squeeze actuator in electrified hose handle.
	Wands not connected.	Make sure wands are properly connected.
	Wand connections not made	Make sure wands are seated properly.
	Automatic resetting motor protector has tripped.	Turn Rainbow off. Leave off for 30 second. Turn Rainbow back on.
The Power Nozzle motor is running but brush is not revolving	Broken belt.	Disconnect power; Remove sole plate; Make sure brush rotates freely; Replace belt.
The Power Nozzle brush is stopped and cannot be rotated by hand	Object lodged in brush chamber.	Disconnect power; Remove sole plate; Remove foreign object; Make sure brush rotates freely.
	Bearing worn out.	Contact an Authorized Rainbow Distributor or Service Center for a replacement brush.
The Power Nozzle is not picking up debris well	Clogged air chamber.	Disconnect power; Remove sole plate; Clear out entire air chamber;
	Clogged wands or hose.	Disconnect power; Remove obstruction; Connect to Rainbow; Make sure air is flowing freely through hose.
	Bristles not in contact with carpet	Make sure sole plate is completely in position before latching; Replace brush if bristles are worn too short.
	Edge cleaning brushes are worn.	Contact an Authorized Rainbow Distributor or Service Center for a replacement edge brushes.

rainbow® fragrances & cleaning solutions

For more information about these products, please contact an Authorized Rainbow Distributor.



rainbow® fragrances

Bring the sweet and refreshing smell of a spring garden or the great outdoors into your home with Rainbow fragrances.

Eucalyptus

Berry

Orange

Lemon

Apple Blossom

Pine

Vanilla

Violet

Gardenia

Spice



the luxury collection

Indulge your senses with the Rainbow® Luxury Collection, available in four intriguing spa scents.

Tea Tree Mint

Mandarin Rosewood

Orange Ginger

Lavender Juniper



fresh air

This highly-concentrated deodorizer and air freshener solution alleviates objectionable household odors such as fish, tobacco, cabbage, paint, etc., while you clean.



clean floor

Rainbow Clean Floor solution is ideal for thoroughly cleaning linoleum or tile floors. Just spread on Clean Floor solution in and let it do the work.



aquamate®

Specially formulated for use with the Rainbow AquaMate, the AquaMate Carpet Cleaning solution combines cleaner, deodorizer, protector and reconditioner for superior cleaning results.



rexafoamer

Rexafoamer Shampoo solution quickly removes unsightly traffic film from rugs and carpets. No hard scrubbing required. Cleanses thoroughly, dries quickly.

LIMITED WARRANTY

Rexair provides to its independent Authorized Rainbow Distributors, and only to them, a written four (4) year warranty on the Rainbow Cleaning System and attached accessories and an eight (8) year warranty on the vacuum cleaner motor/electronic controller. Replacement parts can be new or remanufactured as provided at Rexair's sole discretion. These warranties do not cover normal wear-and-tear arising from usage of the products. Even though Rexair, as the manufacturer, does not deal directly with the consumer nor provide the consumer with a written warranty, the law imposes certain responsibilities on all manufacturers who make consumer products. The products must not be defective and must be generally fit for their intended uses. These implied warranties of merchantability and fitness are honored by Rexair. Further, Rexair requires each Authorized Distributor to pass through to the consumer, by way of the Authorized Distributor's own written warranty, the benefit of Rexair's warranty to such Distributor.

Rexair sells the Rainbow to its independent Authorized Rainbow Distributors for resale by those Distributors and their agents solely through in-home demonstrations to ultimate user-owners. Any other sale, including sales through the Internet, is strictly prohibited. Any product purchased in any other sale is not covered by the Authorized warranties.

The manufacturer, Rexair, has established a proud heritage of selling a superior product through independent Authorized Distributors for more than 75 years, and is committed to the service and support of Rainbow owners.

Rexair sells the Rainbow Cleaning System only to independent Authorized Distributors who are experienced in direct in-the-home selling. These Authorized Distributors assume responsibility for the legitimate distribution and service of the Rainbow Cleaner directly through their own dealers, or indirectly through independent sub Distributors and their dealers.

Rexair has no agreement or legal relationship with the independent resellers who acquire products directly or indirectly from an Authorized Distributor, and can only attempt to correct any customer complaints about such resellers by acting through the responsible Authorized Distributor. Rexair's announced policy is to hold each Authorized Distributor responsible for remedying any complaint from any member of the buying public relating to sales or service by any of these independent resellers.

Rexair further requires that each Authorized Distributor make prompt and workmanlike service available through its own service outlets or through responsible independent service outlets in those communities in which it sells Rexair products through its independent sub Distributors and dealers.

Do not lose the name and address of the Dealer or Distributor from whom you bought the Rainbow Cleaner. Contact him or her for advice on caring for your Rainbow, warranty coverage, service and the nearest service outlet. If you are unable to contact them, or feel you are not receiving proper assistance from the Authorized Distributor, feel free to contact Rexair's customer service department for assistance. They will provide you the name, address and phone number of an Authorized Distributor for your area.



Clean Air Delivery Rate

Rainbow
e SERIES e'

Certified Rating

From air cleaner to air cleaner, compare the Clean Air Delivery Rate (CADR) numbers. First, look at suggested room size. Then refer to the tobacco smoke, dust and pollen CADR numbers.

The Rainbow[®] e' is suggested for use in a single closed room up to 90 square feet.

Room size ratings conform to the AHAM Certification Program criteria of 80% smoke reduction. Higher Clean Air Delivery Rates provide improved performance in all room sizes. Portable air cleaners will be much more effective in rooms where all doors and windows are closed.

GADR Ratings

Tobacco Smoke: 55

Dust: 61

Pollen: 67

The higher the numbers, the faster the unit filters the air.

These values represent performance that can be expected within the first 72 hours of operation. Subsequent performance may vary with use.

Association of Home Appliance Manufacturers

AHAM



NOTES



註釋

保養條款

Restair僅向其獨立的授權經銷商提供 Rainbow 清潔系統及其配件為期四 (4)年的品質保養, 以及摩打和電路板為期八(8)年的品質保養。更換零件採用全新或再造的配件, 完全由 Restair 生產商自行決定。這些品質保養不包括產品在使用過程中所產生的正常磨損和消耗。雖然作為生產商的 Restair 並不直接與消費者交易, 也不直接向消費者提供書面的品質保養, 但根據法律規定, 所有消費類產品製造商均負有某些責任, 產品不得有缺陷並且總體上必須符合產品的預期使用用途。Restair 願意履行這些產品銷售性和適用性的保養。另外, Restair 要求其授權的經銷商向消費者提供其自身的書面品質保養, 使消費者也可在授權經銷商處享受到 Restair 生產商提供的保養服務。

Restair授權給Rainbow經銷商銷售Rainbow清潔系統, 再由經銷商以家庭示範的方式直接銷售給用戶。本公司嚴禁以任何其他方式進行銷售。從任何其他方式購買的產品均無法享受本公司的保養服務。

製造商Restair透過獨立的授權經銷商銷售優質產品, 創造了引以自豪的光榮傳統, 至今已有75年以上歷史, 並且我們致力於為Rainbow用戶提供服務和支援。

REXAIR生產商僅銷售Rainbow清潔系統給那些在家庭直銷方面具有豐富經驗的獨立授權經銷商。經本公司授權的獨立經銷商直接透過其附屬代理商, 或間接透過獨立的經銷商, 合法銷售Rainbow產品並提供售後服務。

Restair與直接或間接從授權經銷商處獲取本公司產品的獨立代銷商之間並未簽署任何協議, 也不存在任何法律上的關係; 所以, 客戶若對此類獨立代銷商不滿, 本公司只能透過相關的授權經銷商予以跟進。Restair的政策是: 任何由獨立代銷商提供的銷售或服務所引起的客戶的投訴, 均由其相關的授權經銷商來解決。

在透過獨立的經銷商及其代理商銷售Restair產品的地區, Restair還要求每個授權經銷商透過自己的服務網點或負責任的獨立服務網點, 向客戶提供即時及專業的維修服務。

請保管好向您出售Rainbow清潔系統的經銷商名稱及地址。如需Rainbow的維修條款、保修範圍、維修服務及就近的服務位置, 請向他們諮詢。如果您無法與其取得聯絡, 或感覺授權經銷商未提供正確的幫助, 請隨時聯絡Restair的客戶服務部。他們將向您提供您所在地的授權經銷商的名稱、地址和電話號碼。



Clean Air Delivery Rate

Rainbow
e SERIES e²

Certified Rating

對空氣清新機進行相互比較時, 要比較各自的清新空氣輸送率(CADR: Clean Air Delivery Rate)。首先, 要看所建議的房間尺寸, 然後要查香菸、灰塵和花粉的清新空氣輸送率(CADR)的數目字。

CADR 等級:

煙味: **55**

灰塵: **61**

花粉: **67**

建議在一個最大不超過8平方米的單獨封閉的房間內使用 Rainbow® e²。

數目越高, 其他濾器可以過濾空氣的
速度就越快。

房間大小的分級符合 AHAM 認證方案 (AHAM Certification Program) 80% 的除煙標準。對於所有尺寸的房間來說, 較高的清新空氣輸送率 (Clean Air Delivery Rate) 數字表示可以提供更佳的性能。使用手提式空氣清潔器時, 將房間中門窗關閉, 會使效果更佳。

這些數值代表了產品在使用首72小時內可以防護的性能, 其性能可能根據使用的變化而有所不同。

Association of Home Appliance Manufacturers

AHAM

rainbow® 香薰及清潔劑.

有關這些產品的更多資訊，請聯絡授權 Rainbow 經銷商。



rainbow® 香薰系列

使用 Rainbow® 香薰，將春天花園的芳香和清新的氣味，或美妙的室外空氣帶入您的家中。

尤加利
桑葚
香橙
檸檬
蘋果

清松
雲呢拿(香子蘭)
紫羅蘭
梔子花(白蘭花)
香料



尊貴系列

在我們的尊貴系列中放鬆您的感官享受，共有四種迷人的 SPA 氣味供您選擇。

茶樹薄荷
紫檀橘子

薑橙
薰衣草與杜



新鮮空氣

這種高濃度的空氣清新劑可以在您清潔的同時，減輕魚腥味、煙味、捲心菜味、油漆味等令人討厭的家中異味。



清潔地板

Rainbow 清潔地板溶液是徹底清潔地板或瓷磚地板的理想選擇。只需在地板上噴灑清潔溶液，讓它自己發揮功效。



aquamate®

AquaMate 地毯清潔劑是專為 Rainbow AquaMate 配製的溶液，集清潔、除味、保護和翻新於一身，操作簡便，清潔效果一流。



rexafoamer

Rexafoamer 潔液能迅速地除去地毯上因行走而造成的不雅觀的污漬層。無需用力刮擦。徹底清潔和乾透。

問題	可能的原因	解決方法
機器運轉發燙；發出燒焦的氣味。	HEPA中和器發霉。	卸下HEPA中和器，清理或更換。
	Rainbow 擱置在潮濕的水盆上。	不要將 Rainbow 擱置在潮濕的水盆上。
	軟管、直管、附件或 Power Nozzle 堵塞。	去除阻塞處的堵塞物。
異常的聲音、噪音或振動。	Rainbow 沒有正確安放在水盆上。	確保 Rainbow 正確安放在水盆上並扣緊。
	分離器阻塞或變聯。	卸下分離器並進行清理。
Power Nozzle 電動拍打器不能操作	水位高於水盆中的中心圓頂。	將水盆倒空，並充水至正確的水位。
	機板鎖定開關位於關閉位置。	將開關移至中間位置，並按壓板機。
	把手開關未起動。	必須擠壓電動軟管把手中的促動器。
	直管未連接。	確保直管連接正確。
	直管未能接通電源。	確保直管接好電源位置。
	摩打自動重置功能出誤。	將 Rainbow 的電源關閉。等待 30 秒。再將 Rainbow 的電源打開。
	Power Nozzle 操作正常，但刷子不轉動。	橡膠帶斷裂。
Power Nozzle 刷子停轉，並且無法用手轉動。	物體堵塞在刷子腔中。	關閉電源；卸下底板；去除異物；確保刷子可自由轉動。
	滾刷走珠磨損。	聯絡授權 Rainbow 經銷商或服務中心以獲得更換刷子。
Power Nozzle 無法充分吸取碎屑。	氣流堵塞。	關閉電源；卸下底板；清潔整個拍打器。
	直管或軟管堵塞。	關閉電源；去除堵塞物；連接至 Rainbow；確保空氣可自由流經軟管。
	刷子毛無法接觸到地毯。	鎖緊前，確保底板完全到位；如果刷子毛由於磨損變得太短，則更換刷子。
	邊緣清潔刷子磨損。	聯絡授權 Rainbow 經銷商或服務中心以獲得更換邊緣刷子。

排除故障指南

Rainbow已通過嚴緊測試和檢查。如果出現小問題，下列排除故障程式可助找到並解決問題。如果問題仍然無法解決，請聯絡Rainbow授權經銷商。

警告： 對本機進行維修前，請斷開電源。否則可能導致電擊或人身傷害。

問題	可能的原因	解決方法
Rainbow 電機不運轉。	Rainbow未在水盆上扣好。	確定水盆旁邊的鎖扣鎖緊了。
	電源插頭沒有插牢。	將電源插頭牢固地插入插座或換用另外一個插座。
	進氣口的濾網被碎屑堵塞。	徹底清除碎屑。
	摩打自動重置系統斷路。	將 Rainbow 的電源關閉。等待 30 秒。再將 Rainbow 的電源打開。
	電線、電源開關或Rainbow有損壞。	聯絡授權 Rainbow 經銷商或服務中心。
氣流明顯降低。	Rainbow 沒有正確地放置在水盆上。	確保Rainbow完全安放並扣緊在水盆上。
	軟管、直管、附件或 Power Nozzle 堵塞。	去除阻塞處的堵塞物。
	HEPA中和器需要清理或更換。	卸下HEPA中和器，清理或更換。
	Rainbow 低速運轉。	將電源開關調至高速
	分離器阻塞或變髒。	卸下分離器並進行清理。(參見第 10 頁)
灰塵外泄。	水盆中水位變低。	給水盆充水至正確的水位。
	水盆中的污水過於污濁。	更換潔淨的水。
	HEPA中和器中出現磨礮。	聯絡授權 Rainbow 經銷商或服務中心。
水盆中的水有大量泡沫。	水盆中出現滑膩的污染物。	將水換成清水。
	水盆中水位過高。	將水盆倒空，並充水至正確的水位。
裝置發出黴臭。	水盆在使用之後沒有得到清洗或沒將污水倒空。	清洗水盆，並在清洗的時候使用空氣除味清新劑。
	分離器阻塞或變髒。	卸下分離器並進行清理。(參見第 10 頁)

用戶故障排除指南

Rainbow®具有在某些異常情況下斷開到附件軟管電源的功能。



指示燈狀態	可能原因	糾正措施
始終亮著	設備打開，但軟管手柄扳機在“鎖緊”(locked-on)位置(電動噴嘴將發出脈動聲音)。	放開軟管手柄扳機鎖3秒鐘。 恢復正常使用。
閃爍2次， 重複	電動噴嘴刷輓受阻。	關閉設備/拔掉設備的電源插頭。 清除電動噴嘴刷輓中的碎屑。 恢復正常操作。
	電氣連接部位受潮。	關閉設備/拔掉設備的電源插頭。 乾燥電氣連接部位。 恢復正常操作。 如果糾正措施沒有解決問題： 聯繫授權經銷商或服務中心。
閃爍4次， 重複	電氣連接部位受潮。	關閉設備/拔掉設備的電源插頭。 乾燥電氣連接部位。 恢復正常操作。 如果糾正措施沒有解決問題： 聯繫授權經銷商或服務中心。
閃爍6次， 重複	電氣軟管或棍連接有問題。	聯繫授權經銷商或服務中心。

更換 *power nozzle™* 橡膠帶

要獲得最佳的性能，我們建議您每隔12-18個月，或當您發現清潔效果變差時更換拍打器的橡膠帶。拍打器隨附一條更換橡膠帶，僅需幾分鐘即可輕鬆完成更換。後備之橡膠帶放置在底板下帶槽位置上。有關更換橡膠帶的細則，請聯絡 Rainbow 授權經銷商。

警告： 維修時，請務必從電源插座上撥出插頭。

1. 將 Power Nozzle 倒放。用一個平頭螺絲起子或一枚硬幣，向左轉動緊固件 1/4 圈（逆時針）。
2. 用兩隻手的拇指向外推底板兩側上的鎖扣，同時提起，以解除鎖定。
3. 接下來，將食指插入靠近輪子旁邊兩側的開口中。在推入的同時向上拉側邊的鎖扣，以提起底板。
4. 向前旋轉刷毛滾軸裝置（注意滾筒上部朝下），將其卸下。
5. a) 用手指將磨損或斷裂的皮帶滑下電機軸；b) 將刷棍提出，並取下磨損的皮帶。
6. 把新皮帶套在刷棍組件的末端。沿著皮帶輪定位好新皮帶。
7. a) 將刷毛滾軸上部朝下，滾筒居中置於兩邊調整片的頂部。滑動皮帶至馬達連杆末端上部；b) 向前旋轉刷毛滾軸裝置直至滾筒正面朝上。朝您自己的方向旋轉刷毛滾軸，以將皮帶置於滑輪中央。
8. 將底板放到 Power Nozzle 蓋上面。向下按，直到前面和兩側的和後面的鎖扣卡入並鎖定到位。
9. 用一個平頭螺絲起子或一枚硬幣，向右轉動緊固件 1/4 圈（順時針）以鎖定底板。裝配完成。

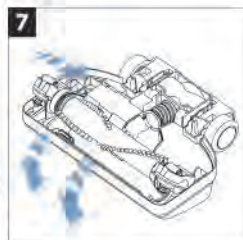
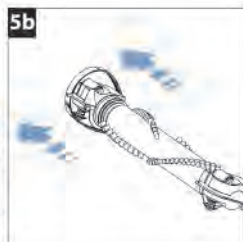
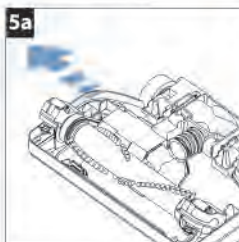
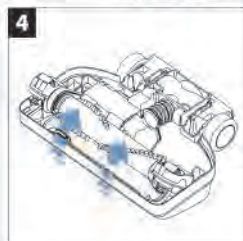
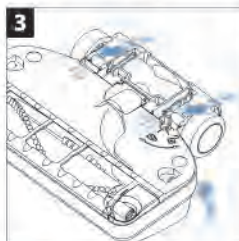
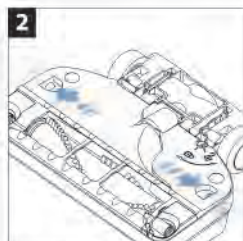
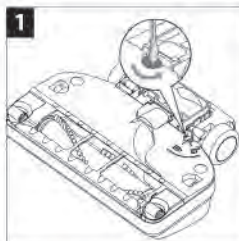

power nozzle™ 裝配和操作

裝配

- 使用Power Nozzle前，請遵從第8-9頁上的《快速入門指南》，把Rainbow準備好。
- 將不鏽鋼直管向下插入Power Nozzle的接駁位置，直至聽到按鈕鎖定到位之聲音。

操作

- 將 Rainbow 插上電源。
- 將 Rainbow 功率開關轉至「高速」模式。
- 在軟管把手上，將氣流控制通風孔轉至「全功率」。
- 要脫離豎立位置，請將您的左腳放到 Power Nozzle 上面。然後，抓住直管組合件並向後拉。
- 扣壓軟管把手上的機板來啟動Power Nozzle。鬆開機板以關閉Power Nozzle。（參見第 7 頁）
- 用任意和簡易的動作，在地毯上緩慢地前後拖動 Power Nozzle。讓 Power Nozzle 和 Rainbow 自己發揮功效。
- 要將 Power Nozzle 鎖定在豎立位置，請將您的左腳放到 Power Nozzle 上面。然後，抓住直管組合件並向前推，直到直管系統完全與鎖定卡舌接合。
- 要把Power Nozzle與直管分開，請按下腳踏以釋放裝置。

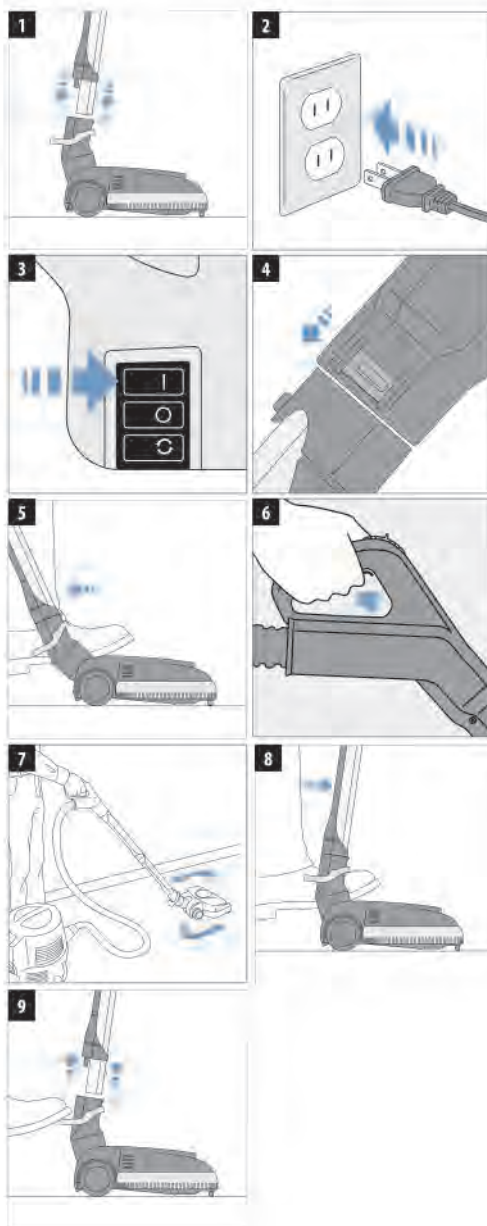

rainbow power nozzle™* (強力拍打器)

Rainbow Power Nozzle 可以輕易清除大小地毯深處的塵埃。其強力轉動刷子可以令棉絨、線頭、毛髮和灰塵松脫，令地毯回復柔軟潔淨。欲清潔不同表面，可透過調整滾筒來調整 Rainbow Power Nozzle 的高度。設定氣流控制為「全功率」。

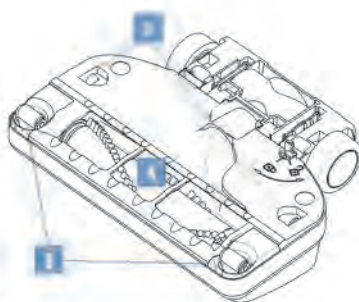

* 作為選擇性的配件。如需更多資訊，請聯絡授權 Rainbow 經銷商。

1. 釋放接駁腳踏
2. 旋轉臂
3. 可調整滾筒

4. 刷輓
5. 底板開合釋放制

聯絡授權 Rainbow 經銷商以獲得 Power Nozzle 更換皮帶和其他部件。

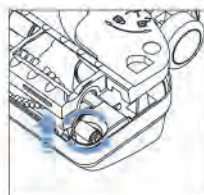

可調整滾筒...

Rainbow Power Nozzle 在兩側均具備可調整滾筒，方便清潔，不留死角。

低：大多數地毯和表面選擇的經典設置。

高：用於厚堆積地毯，以及特殊應用。

警告： 為避免電擊危險，請勿使用 Power Nozzle 吸水或任何其他液體。

注意： 僅使用 Power Nozzle 吸乾爽的物质。勿在室外使用，或在潮濕的表面上使用。

注意： 勿在光地板或硬木地板上使用。Power Nozzle 僅適合地毯或床褥上使用。

注意： 嚴禁使用 Rainbow Power Nozzle 吸取硬物或尖銳物品。大頭針、髮夾、大頭釘、蠟筆和鉛筆根等物品，避免導致刷輓或皮帶受到不必要之損壞。

注意： 維修時，請務必從電源插座上拔離插頭。

注意： 此拍打器之摩打是恆久保持潤滑和密封，不用添加潤滑劑。

注意： 在硬面光地板上使用 Rainbow Power Nozzle 之前，請先諮詢地材製造商。然後在不顯眼的位置試用 Power Nozzle，核實使用本產品不會損壞地板。

透過配件增強 rainbow® 的功能

有關這些產品的更多資訊，請聯絡授權 Rainbow 經銷商。



AquaMate地毯清潔器使您得到專業的清潔效果，可省卻僱用專業人員清洗地毯的費用。AquaMate適用於大多數類型的地毯。能夠快速去除飲料、寵物以及沾在鞋上而帶進房間的泥土污漬。與Aquamate地毯清潔劑一起使用，可獲得更佳的清潔效果。



Rainjet能夠處理與地拖相同之清潔效果，它配有自給式的儲水器。其海綿和刷子附件可在瓷磚或硬地上交替使用。與地板清潔劑一起使用，可獲得更佳的清潔效果。



RainbowMate造型輕巧，讓您可以徹底清潔面積較小的布製品，如地毯式樓梯，布藝製品和汽車絲絨座椅等。



Rainmate 外型優美，只要在水盆中添加少許你最喜愛的香薰油，即可產生如大自然一般的芬芳氣味。

特大地牆刷

14英寸潤的特大地牆刷覆蓋面積大，讓您可以快速清潔面積較大的區域。

4夸脫 (3.76升) 水盆

提供4夸脫水盆，以進行大型清潔工作，讓您可以較長時間地清潔而無需換水。4夸脫水盆可安裝在Rainbow輪架上，將Rainbow的清潔能力擴大一倍。

加長軟管

14英尺的加長軟管增加了Rainbow附件和Power Nozzle的清潔範圍。清潔大樓梯和天花板更方便。

Rexafoamer (發泡器)

Rexafoamer發泡器將其專用液體製造出「乾洗」泡沫。能使您在家中經濟實惠地對地毯作自行清洗而獲得專業的效果。與Rexafoamer專用液一起使用，可獲得一流的清潔效果。

家居全面清潔解決方案

要潔淨寢具...

使用Rainbow動力噴嘴。使用Rainbow清潔系統，可徹底清潔床墊、彈簧床墊、基架、枕頭、輕便小床及睡袋。使用Rainbow動力噴嘴吹松及去除您寢具上的頭髮、皮屑、塵蟎、碎屑及其他顆粒。注意：在細麻布及柔軟的寢具上使用Rainbow動力噴嘴可能導致損害。



吹噴或充氣...

使用充氣工具。Rainbow充氣工具是對氣墊床、沙灘球和其他充氣玩具進行快速充氣的理想選擇。

警告：確保充氣咀鎖定到位。否則在吹氣時，它會從充氣工具頭上飛脫。

使用說明：

1. 取下 Rainbow 背部的排氣口蓋。
2. 將 Rainbow 軟管接到排氣口上。
3. 將充氣工具接到軟管把手直管端。
4. 設定氣流控制為「全功率」。
5. 將充氣工具接到軟管把手上。
6. 仔細地將充氣針頭插入有待充氣的物體的充氣口中。
7. 啟動 Rainbow 在「高速」位置。

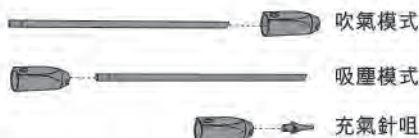
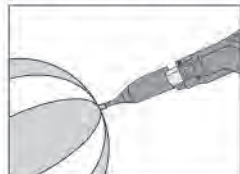

清潔狹窄空間...

使用狹窄空間清潔工具。要對付隱閉性或難以達致之狹窄縫位置，請使用狹窄空間清潔器。這工具用途廣泛，根據您的具體清潔情況，可以與充氣針或長咀吸管清潔器配合使用。提示：狹窄空間清潔器是清潔汽車內部的理想工具。

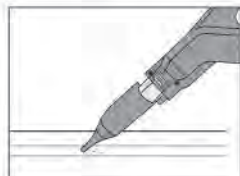

清潔冰箱底部...

使用長咀吸管。可輕鬆地將冰箱或洗衣機底部的灰塵吸走。

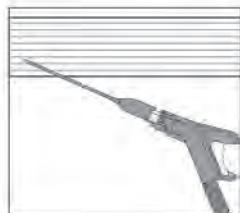

全面的家庭清潔解決方案

獲得清新的水洗空氣...

Rainbow 不單可以為您清潔傢俱、地板和室內陳設，也可以清潔室內空氣！只需將水添加到水盆中，並將 Rainbow 放置到房間中央，並以低速模式運行約一小時。Rainbow 會去除空氣中濃重的異味，並將空間微塵和懸浮粒子鎖留在水中。



消除異味...

使用 Rainbow 空氣清新劑。只需添加少量 Rainbow 空氣清新劑到水盆中，在您進行清潔時，高速迴轉水洗空氣的力量，令整個週邊的異味消除，空氣變得更清新。



香薰氣化...

使用 Rainbow 香薰油。只需添加少量 Rainbow 特定之香薰油在水中，將 Rainbow 放置在房間的中央，並以低速模式運行，整個房間於數分鐘內充滿怡人的芳香。

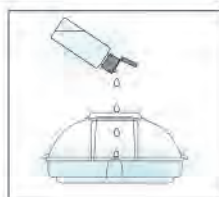

清潔布藝製品...

使用布藝吸頭。深藏在布藝製品內之污垢會令其鮮明色澤變為暗啞。Rainbow 之布藝吸頭能以有效地清除纖維上的塵污和黏附之毛髮。適用於布製沙發、椅子、床墊、枕頭、毛毯、窗簾和毛布玩具等。提示：此配件也能有效地清潔衣物和外套，如羊毛、羽毛大衣和精細的紡織品等。調節氣流控制以配合不同物質吸力強弱要求。

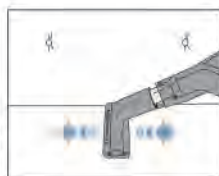

清潔通風位置...

使用除塵刷吸頭。冷氣和室內之通風位置常聚集灰塵，並在室內製造循環空氣污染。柔軟之除塵毛刷能進入排氣槽間，輕鬆清除頑固污垢和滯留的碎屑。設定氣流控制為「全功率」。



枕頭坐墊辟味和回復鬆軟...

將枕頭坐墊或布製玩具放入塑膠氣袋中，把布藝刷裝配在 Rainbow 軟管把手之直管上，並放置於袋內布製物件上面，緊握膠袋連同軟管，打開 Rainbow 抽真空，袋中物件內藏之污氣和異味經真空壓縮處理後會被抽出。不必拿出裝配，半握緊袋口，拿走出氣蓋掩，將軟管拔離入口位並馬上安插在 Rainbow 背部出氣位置，令膠袋膨脹及充滿潔淨水濾之空氣，而令物件回復鬆軟及內藏之氣味回復清新。



全面的家庭清潔解決方案

清潔光地板...

使用地牆刷。對於乾淨而漂亮的硬木地板和瓷磚地板而言，地牆刷在清除表面垃圾和灰塵方面表現極佳。持續使用地牆刷可防止因地地板碎屑造成的劃傷。設定氣流控制為「全功率」。



清潔地毯...

使用 Power Nozzle™* (電動強力拍打器)。強力的電動拍打器可以輕易清除各類大小地毯深藏之塵埃。其強力轉動刷頭可以令地毯上老化之棉絨、線頭、毛髮和灰塵鬆脫，令您的地毯柔順潔淨。拍打器兩旁的小圓刷有助清潔地毯邊緣、牆邊或傢俱旁邊的灰塵。設定氣流控制為「全功率」。



除塵...

使用除塵刷。鑑於Rainbow操作時能鎖綁塵埃在水中並能同步釋放水濾潔淨空氣回室內，所以可減少家居除塵的頻率。但如要保持家居徹底乾淨，請勿忘記在容易忽略的地方進行除塵，例如，窗台、相框、百葉簾、燈罩、網罩、鍵盤、盆栽植物等。清潔精緻物品和類似的易碎物品時，請打開氣流控制通風孔以降低吸力。提示：清潔高處地方，如吊扇葉片、天花和牆身蜘蛛網等，請將除塵刷加插在接駁管上。



清潔牆壁...

使用地牆刷。能清除各種貼有牆紙的牆壁、板間或油漆牆上之灰塵。清潔動作請由上至下。要獲得最佳的清潔效果和避免留下塵污斑紋，請僅讓毛刷的上邊緣接觸牆壁，在牆壁和毛刷底部邊緣之間稍稍留出少許間隙，讓灰塵在接觸刷毛之前被吸除。設定氣流控制為「全功率」。



清潔狹窄的空間...

在狹窄和緊迫的空間可使用縫隙清潔工具，例如，冷暖氣片之間、地板牆腳邊緣、以及坐墊之間的夾縫深處等。設定氣流控制為「全功率」。

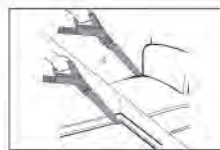

清潔地毯梯間...

使用布藝吸頭。如要清潔鋪有地毯的樓梯，請把 Rainbow 從輪架上取下。在每清潔一個梯階時要把主機放置在对上一級樓梯上，並握穩主機扶手，用布藝吸頭以 90 度位置向下貼地毯面前後推動。設定氣流控制為「全功率」。

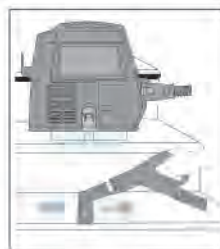

*只適用於選購件之配件。如需更多資訊，請聯絡授權的 Rainbow 經銷商。

全面的家庭清潔解決方案

Rainbow 提供各種清潔工具，完全可以滿足您家中各種清潔活動的需要。

附件	傢俱	坐墊之間	窗上用品	樓梯	地毯樓梯	鋪地毯的地板和小地毯	牆壁	縫隙和狹窄空間
除塵刷	✓		✓					
布藝吸頭	✓		✓	✓				
縫隙清潔工具	✓	✓		✓				✓
地牆刷				✓	✓		✓	
拍打器*					✓	✓		
RainbowMate*	✓			✓				
RainJet*					✓			
地板橡皮拖把*					✓			
Rexafoamer*						✓		
充氣工具 / 狹窄空間清潔器		✓						✓

* 只適用於選購件之配件。如需更多資訊，請聯絡授權的 Rainbow 經銷商。

注意： 在紡織品上使用前，務必清潔附件。如要避免對精緻表面造成磨損，請保持除塵刷刷子毛乾淨。

注意： 請勿使用附件清潔平板電視機或電腦螢幕。

配件的清潔...

地牆刷、除塵毛刷和布藝吸頭均可利用Rainbow 本身之吸咀來吸除黏附在配件上之毛髮和塵污。配件硬膠部份可在視液或肥皂水中清洗。裝回配件時請弄乾。



使用排氣聲浪調節器...

Rainbow 排氣聲浪調節器可用於降低進氣口處的氣流噪音。我們建議您在把 Rainbow 作為吹風機或充氣工具時使用此聲浪調節器。在將Rainbow作為吹風機或充氣工具使用前，把排氣聲浪調節器插入進氣口處即可。



正確使用和保養

為確保你的Rainbow清潔系統能長年累月地正常運作，敬請用戶遵循以下幾種基本保養守則。否則可能會導致清潔效率降低，並可能產生不必要的維修費用。

水位需正確及水太髒要更換...

正確使用水位為水盆中間凸起圓頂部位之水平線。盡量不要只用一盤水作長時間清潔。如吸入之污物令水變為糊狀，請即更換為清水才繼續使用。



永不讓水盆儲存髒水及保持潔淨...

用完Rainbow後，請立即將污水從水盆進氣位置倒掉，並清理水盆內之沉澱雜質，然後用清水或少許視液把水盆徹底清洗並擦乾。

注意：清潔工作完成後，務必取下、倒空並清洗水盆。這將有助於防止水盆散發異味，衍生細菌和形成積垢。僅限手洗。不適用於洗碗機。

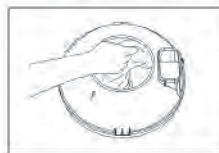
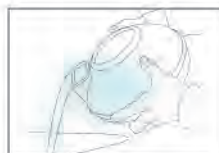

清潔分離器...

要獲最佳清潔效果，應時常把分離器保持潔淨，有需要時可拆出清洗。

警告：如分離器拆出清洗後，必需馬上裝回！切勿在未安裝分離器的情況下操作Rainbow。



清除軟管中的堵塞物...

若您在使用軟管時感覺氣流減弱，有可能是軟管內有物堵塞而導致。解決此問題，先取下主機背部的排氣口蓋，將軟管連接排氣位置，然後將軟把手直管插入主機前面的進氣口中。開動Rainbow並輕抖軟管，管內卡住的污物便會被噴出之氣流沖離到水盆中。



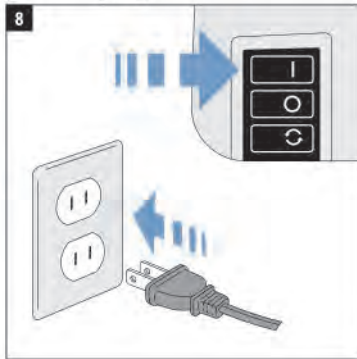
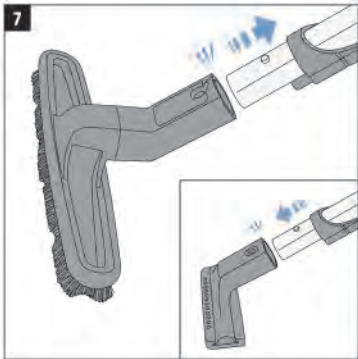
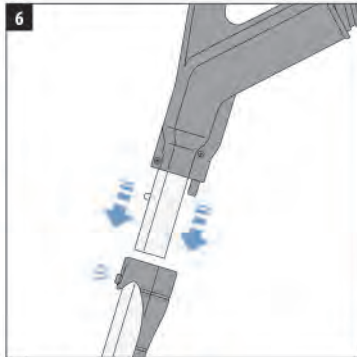
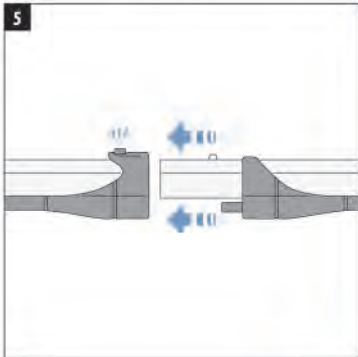
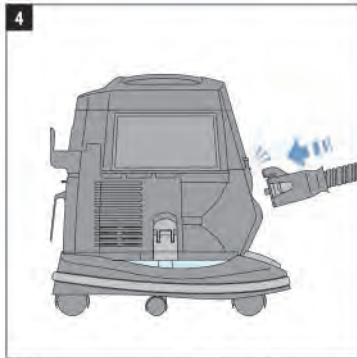
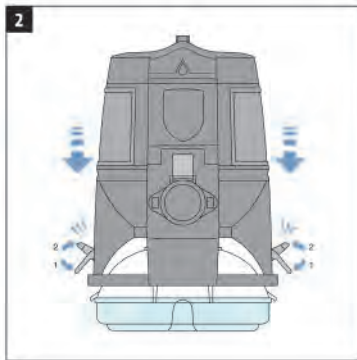
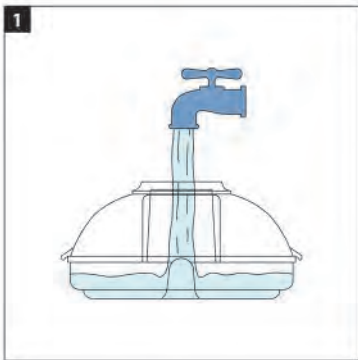

快速入門指南

僅需簡單的幾步，您便可以裝好 Rainbow 並開始用它進行清潔。

1. 水盆加水...

在水龍頭處給水盆加入冷水。水平面以與水盆底部的水位圖拱柱的頂部平齊為宜。加水過多或過少都會降低清潔效果。如發現水盆水量運作時明顯減少時，應注入適量清水。

2. 將 Rainbow 夾到水盆上...

對準並將 Rainbow 放到水盆上面。將 Rainbow 兩側上的水盆扣與沿著水盆邊緣平放，並有劈啪聲扣上。如要將其水盆取下時，只需鬆開兩邊夾扣，然後提起主機。Rainbow 在沒有連接水盆情況下，不能運行操作。

3. 將 Rainbow 放到輪架上...

將 Rainbow 和連接的水盆放在輪架上時，將 Rainbow 的凸出端和輪架的凸出端對準，如圖所示。用腳鎖將 Rainbow 鎖定到位。要鬆開時，按下腳鎖。

4. 連接軟管...

將軟管接頭按入機身的進氣口中，直到聽到一聲脆響，軟管定位為止。如需拆卸，按壓兩個夾扣，從機身中拔出軟管。

5. 連接直管...

將一根直管的外止口插入另一根直管的內止口。將直管按到一起，直到按鈕鎖發出脆響為止。要分開直管時，可按直管上的按鈕並將其拉開。

6. 連接軟管把手直管...

將軟管把手直管插入上面直管的內止口。用力推動，直到按鈕鎖發出脆響為止。要分開時，按直管上的按鈕並將其拉開。

7. 選擇一個附件...

確定您要進行的清潔類型（參見第 11 頁上的圖表），然後將所需的附件插入底部直管，或插入手槍式握把軟管把手直管中。按鈕將鎖定到任一直管上的孔中。要分開時，按直管上的按鈕並將其拉開。

8. 啟動 Rainbow...

將插頭插入電源插座中。選擇「高速」，以獲得最佳清潔效果。

功率控制盡在指間

功率選擇開關

功率選擇開關，能控制Rainbow 電機的速度。



高：使用該設定進行一般清潔。

關：關閉整個裝置。

低：使用該設定清潔空氣。(參見第 13 頁)

氣流控制通風孔

軟管把手上的氣流控制通風孔可以開或關閉，以便吸取窗簾等精緻物品時控制氣流，並能使 Power Nozzle 更輕鬆地在厚地毯上拖動。在進行清潔的同時，可以快速地作出正確的調整。

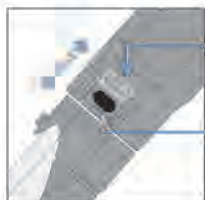

降低氣流：保持通風孔打開，並視乎不同的清潔工作進行調整。

全功率：保持通風孔關閉，獲得最佳清潔效果。

扳機鎖定開關

使用 Power Nozzle、RainbowMate、RainJet 和 AquaMate 時，軟管把手的扳機鎖定開關控制電動軟管的功能。

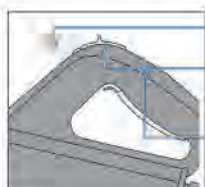

向前位置：鎖定扣板，電源處於關閉狀態。

中間位置：(推薦) 按壓扣板以開啟電源，鬆開以關閉。

向後位置：鎖定扣板，電源處於開啟狀態。

小配件安置架



在清潔多個房間或不同樓層時，可在機身前或接駁直管上安裝小配件安置架，以便攜帶用的小配件，易於轉換作不同清潔之需要。

認識你的 rainbow®



如需購買配件或更換件，請聯絡授權 Rainbow 經銷商。

- | | | |
|-------------|--------------|-------------|
| 1. 電線收藏架 | 12. 分隔器 | 23. 把手起動扣板 |
| 2. 排氣口板 | 13. 水盆 | 24. 軟管把手直管 |
| 3. 排氣口 | 14. 輪架 | 25. 氣流控制通風孔 |
| 4. 排氣聲浪調節器 | 15. 輪架腳鎖 | 26. 縫隙清潔工具 |
| 5. 功率選擇開關 | 16. 高效能隔濾中和器 | 27. 除塵刷 |
| 6. 主機把手 | 17. 噴氣工具 | 28. 布藝吸頭 |
| 7. 主機 | 18. 長嘴吸管 | 29. 電動軟管 |
| 8. 進氣口 | 19. 地牆刷 | 30. 電動拍打器 * |
| 9. 水盆鎖 | 20. 氣袋 (不顯示) | |
| 10. 小配件安置架 | 21. 加長接駁直管 | |
| 11. 分隔器固定螺帽 | 22. 手槍式軟管把手 | |

*圖示中之電動拍打器是選擇性配件

9. (A) 請勿在開口處放置任何物體，使用時，所有開口處都不能有堵塞物；保持開口處清潔使之無灰塵、棉麻纖維、毛髮或任何有可能降低氣流流量的物體；(B) 請勿讓毛髮、衣袖褲腳、手指和其他身體部位靠近開口處轉動件；(C) 清潔樓梯時應特別小心。
10. 請勿吸取任何燃燒或冒煙的物體，如煙頭、火柴或熱灰等。請勿用於吸取汽油一類的易燃易爆液體或在存放此類物品的區域作業。
11. 為避免發生火災或爆炸，請勿在有易燃和/或易爆蒸汽或灰塵的地方使用 Rainbow 或 Rainbow 配件。某些清潔液可能產生此類蒸汽。吸塵前，已經使用過易燃清潔液的地方必須完全乾燥且徹底通風。
12. 本電器使用雙層絕緣的技術。替換時應使用相同的零件。參見雙層絕緣電器維修保養說明。
13. Rainbow 設有水盆連結安全操作裝置，以防水盆未鎖定前開啟電機。操作時請緊遵此安全功能。
14. Rainbow Power Nozzle (電動拍打器) 裝有強力轉動刷子。為避免造成人身傷害，操作時切勿將電動拍打器靠著或靠近衣袖褲腳，首飾，毛髮或身體等表面。
15. 為降低觸電風險，可在本裝置上加裝一個極性插頭（一枚插刃與另一枚不同）。此插頭僅可單向安裝在極性插座上。如果插頭不能完全插入插座，嘗試翻轉插頭。如果仍無法插入，請聯絡合格的電氣維修人員安裝合適的插座。切勿隨意更換插頭。
16. 如電線受損，務須關閉 Rainbow 電源開關，拔下裝置插頭。必須由 Rainbow 授權經銷商更換電源線。
17. 如電源線或插頭損壞，切勿操作。必須找授權代理商進行檢查或維修。
18. 請勿將電源線壓置在地毯下，亦不應在電源線上鋪設傢俱和其他電器，應盡量把阻礙電源行走之物件移開。

雙層絕緣電器的維護

雙層絕緣的電器裝有電套絕緣系統以替代地線。雙層絕緣電器不帶有地線的裝置，也毋須加裝地線。維護雙層絕緣的電器時必須特別小心謹慎，並且要求維修人員對此類系統有徹底的瞭解，所以必須由合格的 Rainbow 維修人員進行維修。更換雙層絕緣電器的零件時，必須使用完全相同的部件。雙層絕緣電器上均標有「DOUBLE-INSULATION」或「DOUBLE-INSULATED」字樣。電器上還可能有「回」字形標記。清潔以外維修必須由授權的 Rainbow 經銷商或服務中心進行。



請保存好這些說明

本電器僅供家用。

請僅按照本用戶手冊的說明來使用 RAINBOW 產品。

rainbowsystem.com

重要安全說明



在使用此電器前，請詳細閱讀以下所有說明，
並僅使用製造商推薦的配件

警告：此電力管內含電線，應定期檢修。如已損壞、劃傷或破裂，切勿使用。避免拾取鋒銳物體。切勿使用或維修已受損的電力管。請聯絡經授權的 Rainbow 經銷商或售後服務中心以進行維修。切勿將手柄浸沒於液體中進行清洗。此電力管僅可搭配 Rainbow 配套附件使用或用於經 Rainbow 清潔程式濕潤的地毯上。接通或斷開電力管或電動噴嘴之前，請確保關閉裝置電源。

警告：由於電器有電擊之危險，所以只能用於規定之用途。所有電器未經允許均不能隨意使用。有電的地方均有可能發生漏電和短路的情形。如果使用者站於有水觸及的地面、地下室或室內，則有可能發生嚴重的電擊。因此，只能在按照本用戶手冊的說明來使用 Rainbow 產品。

注意：特別注意：盡量避免用 RAINBOW 水盆盛載非水溶性物質，包括油性或油脂性的合成物及粉狀物（如煙灰，紙灰燼，陶瓷粉，滑石粉或石膏粉等）。切勿使用 RAINBOW 來吸取具有揮發性或有毒性的物體，也不要在此類物品附近進行操作。

1. 本裝置適用於 8 歲以上兒童及體弱者、欠缺感官或智力功能之人士，或在接受與裝置安全使用與危害理解相關之督導或指示後尚缺乏使用經驗與知識之人士。本裝置不可被視作兒童玩具。兒童在未經監督的情況下不可進行清洗或使用者維護工作。
2. 不使用時，請拔出 Rainbow 插頭。拔出插頭前先關上機器的總開關。緊握插頭，並將其從牆上插座處拔出，以免損壞電源線、插頭、插腳或插座。請勿用電源線來拖拉或提拽機身，或將電源線當作把手使用；在關門或拖拽時應小心，以防夾住電源線與鋒利處或牆角產生磨擦。請勿讓電源線接觸高溫面，亦不要使用破損的電源線或插頭。
3. 插入電源時，切勿抽身離開本裝置。在無人照護時，以及在保養或更換電動噴嘴傳動帶之前，請拔下 Rainbow 電源。
4. 若發現您的 Rainbow 或 Rainbow 配件破損，請勿嘗試操作。若 Rainbow 無法正常運作，如：摔落、損壞、置於戶外或掉入水中，請聯絡 Rainbow 經銷商或服務中心進行檢查。
5. 清潔機器或清除管道堵塞前，必須先關掉 Rainbow 的電源開關，並將插頭從牆上插座處拔出後才能進行清理。
6. 勿與白熾燈的插座並聯，或使用延長電線。請勿使用可攜式變壓器或電壓轉換器。
7. 勿將 Rainbow 或 Rainbow 配件用於清除下水道的堵塞。因下水道的氣體抽進 Rainbow 後，有可能引起爆炸。
8. 當其中一隻手接觸電器的金屬部分、燈座或開關時，另一隻手在任何時候都不可以接觸金屬洗滌槽或冷、熱水管，因為人的身體可能形成一個完整的接地電路。而且潮濕的皮膚表面更會增加了這種危險。請勿用濕手接觸插頭或電器。

REXAIR® 敬告客戶

本公司借此機會恭喜您並感謝您選購 Rainbow 清潔系統。全新的 Rainbow 是超過 75 年不斷進行產品研發和獨創的成果。今天，Rainbow 產品暢銷美國所有 50 個州和世界上超過 75 個國家。我們相信，Rainbow 是目前市場上最有效和功能最齊全的家用清潔系統。

透過妥善的使用和保養，Rainbow 將明顯改善您的室內生活環境，並提供長期可靠的服務。請抽出幾分鐘時間閱讀本指南，並熟悉全新的 Rainbow 清潔系統。

如果您對 Rainbow 產品有任何疑問或遇到任何問題，請聯絡銷售 Rainbow 產品的經銷商或分銷商。如果您無法聯絡經銷商或分銷商，請隨時聯絡 Rexair 的客戶服務部以獲得幫助。



Rexair 很榮幸地成為直銷協會 (DSA) 的會員，並且恪守 DSA 的道德規範。

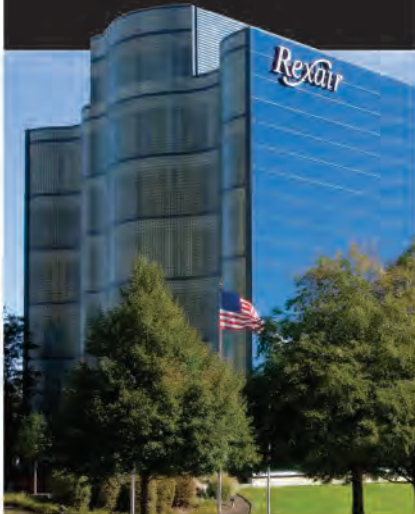

Rainbow® 經由 '美國哮喘和過敏症基金會 (Asthma & Allergy Foundation of America)* 批核，認證是對哮喘和過敏症患者均適合使用之吸塵清潔工具。

CERTIFIED
asthma & allergy
friendly™

Meets
ASP:03:03
Standard for
Vacuum Cleaners



Asthma and Allergy
Foundation of America
aafa.org/certified

*ASTHMA & ALLERGY FRIENDLY and ASTHMA & ALLERGY FRIENDLY 徽標均為 ALLERGY STANDARDS LIMITED 的認證標識和商標。ASTHMA AND ALLERGY FOUNDATION OF AMERICA 是 AAFA 的註冊商標。

Rexair®
LLC

50 W. Big Beaver Road, Suite 350
Troy, Michigan 48084
United States of America

(248) 643-7222
custserv@rexairllc.com
rainbowsystem.com

Rainbow®, RainbowMate®, RainMate®, AquaMate®, Rexair®, The Power of Water®, Wet Dust Can't Fly® 和 Rainbow® 清潔系統的構造均為美國密西根州特洛伊市的 Rexair LLC 公司的註冊商標。

RAINBOW 根據

“塵遇水不能飛揚”

(*Wet Dust Can't Fly*) 之定律，

利用大自然最具威力之原素 - “水”

The Power of Water

有效地處理家中之塵埃和
空氣中之微粒。



客戶服務編號

Rexair 乃 Rainbow 之製造商，為對其客戶和產品作出優良之保證，所有 Rainbow 主機 (Power Unit) 和 電動拍打器 (Power Nozzle) 均編印一個獨有之機身序號 (Serial Number) 以便給客戶提供以下的證明和查核：

- ✓ 擁有權之識別
- ✓ 證明其產品已通過品質安全檢測
- ✓ 經銷商對其產品售後保用資料查核
- ✓ 證明其產品乃原廠生產

請將序列號記錄在下方空白處，以便日後參考。所有真品 Rainbow 和 Power Nozzle 新機出售時均應有此序列號。對沒有此序列號的產品，Rexair 不對其產地、出廠日期或機器狀況負任何責任。如果您在 Rainbow 和 Power Nozzle 上無法找到此序列號，請聯絡 Rexair 的客戶服務部。

RAINBOW (機身序號)

型號: e2-73 db(A)



授權 RAINBOW 經銷商

名稱	
地址	
城市/州/郵遞區號	
電話	
電郵地址	

請聯絡您當地經銷商 Rainbow 之授權經銷商，瞭解保用期間和維修服務費。



rainbowsystem.com

REXAIR LLC | TROY, MICHIGAN

© 2011 REXAIR LLC | R15636B-3 | PRINTED IN U.S.A.